

**WILLIAM PERKINS
SURVEY A-621**

THIS MAP WAS COMPILED FROM SURVEYS BY OTHERS AND PLATS FILED IN THE COUNTY CLERK'S OFFICE, HARRIS COUNTY, TEXAS.

TO THE BEST OF MY KNOWLEDGE AND BELIEF, THIS MAP ACCURATELY REFLECTS THE CURRENT BOUNDARIES OF HARRIS COUNTY WATER CONTROL AND IMPROVEMENT DISTRICT NO. 119.

Troy M. Bordenon
TROY M. BORDENON, P.E.
DATE: 6/11/13

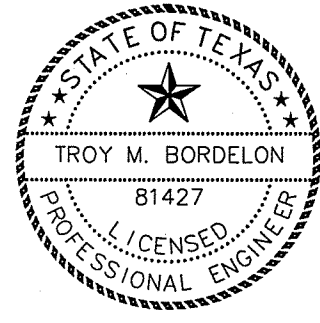

THE UNDERSIGNED DOES HEREBY CERTIFY THAT THIS MAP CORRECTLY IDENTIFIES THE BOUNDARIES OF THE HEREIN DESCRIBED WATER CONTROL AND IMPROVEMENT DISTRICT. THIS DOCUMENT WAS PREPARED UNDER RULE 22 TAC 663.21, DOES NOT REFLECT THE RESULTS OF AN ON THE GROUND SURVEY, AND IS NOT TO BE USED TO CONVEY OR ESTABLISH INTEREST IN REAL PROPERTY, EXCEPT THOSE RIGHTS AND INTEREST IMPLIED OR ESTABLISHED BY THE CREATION OR RECONFIGURATION OF THE BOUNDARY OF THE POLITICAL SUBDIVISION FOR WHICH IT WAS PREPARED.

Andrew Lonnie Sikes
DATE: JUNE 11, 2013
ANDREW LONNIE SIKES
REGISTERED PROFESSIONAL
LAND SURVEYOR
TEXAS REGISTRATION NO. 2914



WE, THE UNDERSIGNED MEMBERS OF THE BOARD OF DIRECTORS OF HARRIS COUNTY WATER CONTROL AND IMPROVEMENT DISTRICT NO. 119, DO HEREBY CERTIFY THAT THIS IS A COMPLETE AND ACCURATE MAP SHOWING THE BOUNDARIES OF SAID DISTRICT.

Andrew R. Phelps
ANDREW R. PHELPS
PRESIDENT

John Soileau
JOHN SOILEAU
VICE PRESIDENT

William Manning
WILLIAM MANNING
SECRETARY, RECORDS MANAGEMENT OFFICER

Robert Williams
ROBERT WILLIAMS
ASST. SECRETARY, TREASURER, INVESTMENT OFFICER

THE STATE OF TEXAS
COUNTY OF HARRIS

BEFORE ME, THE UNDERSIGNED, A NOTARY PUBLIC IN AND FOR SAID COUNTY AND STATE, ON THIS DAY PERSONALLY APPEARED ANDREW R. PHELPS, KNOWN TO ME TO BE THE PERSON AND OFFICER WHOSE NAME IS SUBSCRIBED ABOVE AND THAT HE EXECUTED THE SAME IN THE CAPACITY THEREIN STATED. GIVEN, UNDER MY HAND AND SEAL OF OFFICE THIS, THE 10TH DAY OF JUNE, 2013.

Andrew R. Phelps
NOTARY PUBLIC IN AND FOR THE STATE OF TEXAS
Commission Expires 12-16-2015

THE STATE OF TEXAS
COUNTY OF HARRIS

BEFORE ME, THE UNDERSIGNED, A NOTARY PUBLIC IN AND FOR SAID COUNTY AND STATE, ON THIS DAY PERSONALLY APPEARED WILLIAM MANNING, KNOWN TO ME TO BE THE PERSON AND OFFICER WHOSE NAME IS SUBSCRIBED ABOVE AND THAT HE EXECUTED THE SAME IN THE CAPACITY THEREIN STATED. GIVEN, UNDER MY HAND AND SEAL OF OFFICE THIS, THE 10TH DAY OF JUNE, 2013.

William Manning
NOTARY PUBLIC IN AND FOR THE STATE OF TEXAS
Commission Expires 12-16-2015

THE STATE OF TEXAS
COUNTY OF HARRIS

BEFORE ME, THE UNDERSIGNED, A NOTARY PUBLIC IN AND FOR SAID COUNTY AND STATE, ON THIS DAY PERSONALLY APPEARED ROBERT WILLIAMS, KNOWN TO ME TO BE THE PERSON AND OFFICER WHOSE NAME IS SUBSCRIBED ABOVE AND THAT HE EXECUTED THE SAME IN THE CAPACITY THEREIN STATED. GIVEN, UNDER MY HAND AND SEAL OF OFFICE THIS, THE 10TH DAY OF JUNE, 2013.

Robert Williams
NOTARY PUBLIC IN AND FOR THE STATE OF TEXAS
Commission Expires 12-16-2015

THE STATE OF TEXAS
COUNTY OF HARRIS

BEFORE ME, THE UNDERSIGNED, A NOTARY PUBLIC IN AND FOR SAID COUNTY AND STATE, ON THIS DAY PERSONALLY APPEARED JOHN SOILEAU, KNOWN TO ME TO BE THE PERSON AND OFFICER WHOSE NAME IS SUBSCRIBED ABOVE AND THAT HE EXECUTED THE SAME IN THE CAPACITY THEREIN STATED. GIVEN, UNDER MY HAND AND SEAL OF OFFICE THIS, THE 10TH DAY OF JUNE, 2013.

John Soileau
NOTARY PUBLIC IN AND FOR THE STATE OF TEXAS
Commission Expires 12-16-2015

David M. Marks
NOTARY PUBLIC IN AND FOR THE STATE OF TEXAS
Commission Expires 12-16-2015

PINE GLEN SUBDIVISION (UNRECORDED)

HOLLOW GLEN SUBDIVISION (UNRECORDED)

ROBERT FOREST BRYER
H.C.C.F. NO. U903620

TERRY & BEVERLY PIPES
H.C.C.F. NO. V159863

DAVID MIDDLETON SURVEY A-536
H.C.C.F. NO. 20060080140

HARRIS COUNTY WATER CONTROL & IMPROVEMENT DISTRICT NO. 119
H.C.C.F. NO. X873127

H.C.C.F. NO. U094584
H.C.C.F. NO. U243884

CHAMPION LAKE ESTATE SUBDIVISION
VOL. 536, PG. 080, H.C.M.R.

NOTARY PUBLIC IN AND FOR THE STATE OF TEXAS
Commission Expires 12-16-2015

THE STATE OF TEXAS
COUNTY OF HARRIS

BEFORE ME, THE UNDERSIGNED, A NOTARY PUBLIC IN AND FOR SAID COUNTY AND STATE, ON THIS DAY PERSONALLY APPEARED WILLIAM MANNING, KNOWN TO ME TO BE THE PERSON AND OFFICER WHOSE NAME IS SUBSCRIBED ABOVE AND THAT HE EXECUTED THE SAME IN THE CAPACITY THEREIN STATED. GIVEN, UNDER MY HAND AND SEAL OF OFFICE THIS, THE 10TH DAY OF JUNE, 2013.

William Manning
NOTARY PUBLIC IN AND FOR THE STATE OF TEXAS
Commission Expires 12-16-2015

THE STATE OF TEXAS
COUNTY OF HARRIS

BEFORE ME, THE UNDERSIGNED, A NOTARY PUBLIC IN AND FOR SAID COUNTY AND STATE, ON THIS DAY PERSONALLY APPEARED ROBERT WILLIAMS, KNOWN TO ME TO BE THE PERSON AND OFFICER WHOSE NAME IS SUBSCRIBED ABOVE AND THAT HE EXECUTED THE SAME IN THE CAPACITY THEREIN STATED. GIVEN, UNDER MY HAND AND SEAL OF OFFICE THIS, THE 10TH DAY OF JUNE, 2013.

Robert Williams
NOTARY PUBLIC IN AND FOR THE STATE OF TEXAS
Commission Expires 12-16-2015

THE STATE OF TEXAS
COUNTY OF HARRIS

BEFORE ME, THE UNDERSIGNED, A NOTARY PUBLIC IN AND FOR SAID COUNTY AND STATE, ON THIS DAY PERSONALLY APPEARED JOHN SOILEAU, KNOWN TO ME TO BE THE PERSON AND OFFICER WHOSE NAME IS SUBSCRIBED ABOVE AND THAT HE EXECUTED THE SAME IN THE CAPACITY THEREIN STATED. GIVEN, UNDER MY HAND AND SEAL OF OFFICE THIS, THE 10TH DAY OF JUNE, 2013.

John Soileau
NOTARY PUBLIC IN AND FOR THE STATE OF TEXAS
Commission Expires 12-16-2015

David M. Marks
NOTARY PUBLIC IN AND FOR THE STATE OF TEXAS
Commission Expires 12-16-2015

TRACT 3
304.71 ACRES

TRACT 3
304.71 ACRES

DAVID MIDDLETON
SURVEY A-536

A. LEWIS SURVEY A-506

NOTES:
1) HARRIS COUNTY WATER CONTROL AND IMPROVEMENT DISTRICT NUMBER 119 (H.C.W.C. & I.D. NO. 119) RECORDED UNDER FILM CODE NUMBER 533-02-0777, OFFICIAL PUBLIC RECORDS OF REAL PROPERTY OF HARRIS COUNTY, TEXAS.

DISTRICT AREA	
TRACT 1	519.53 AC.
TRACT 2	77.04 AC.
TRACT 3	304.71 AC.
TRACT 4	4.54 AC.
TOTAL AREA IN DISTRICT	905.82 AC.

E. BALLARD SURVEY A-158

DEED INFORMATION:
A DENNIS L. HANDLEY
H.C.C.F. NO. L992077
LOUIS T. GUTHRIE, AND
WIFE, CHERYL L. GUTHRIE
H.C.C.F. NO. Y574172
CALL 4.5371 AC.

TRACT 4
4.54 ACRES

E. BALLARD SURVEY A-158

TRACT 2
77.04 ACRES

LINE	BEARING	DISTANCE
L1	N 59°05'30" E	268.29'
L2	N 31°33'17" W	325.83'
L3	N 59°05'08" E	74.19'
L4	S 30°42'28" E	348.13'
L5	N 59°07'10" E	438.18'
L6	S 76°12'11" E	42.67'
L7	S 31°32'07" E	462.00'
L8	S 31°31'48" E	284.46'
L9	N 31°44'04" W	298.31'
L10	N 25°22'30" W	133.44'
L11	S 64°51'29" W	55.05'
L12	S 32°12'54" E	389.94'
L13	N 63°38'09" W	23.37'
L14	N 00°15'28" W	33.76'

**R.T. BLACKBURN
SURVEY A-168**

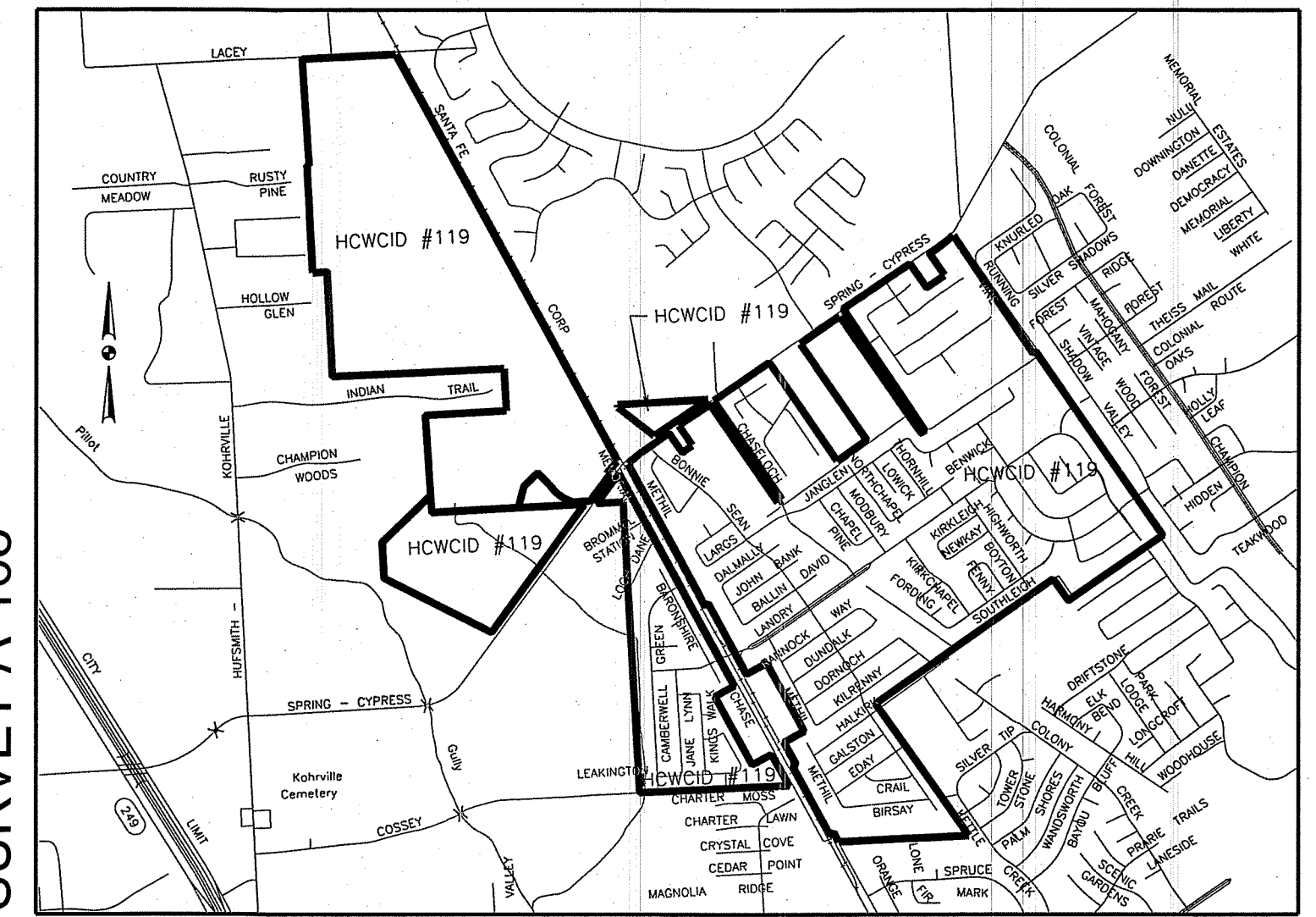

VICINITY MAP: 1" = 2000'

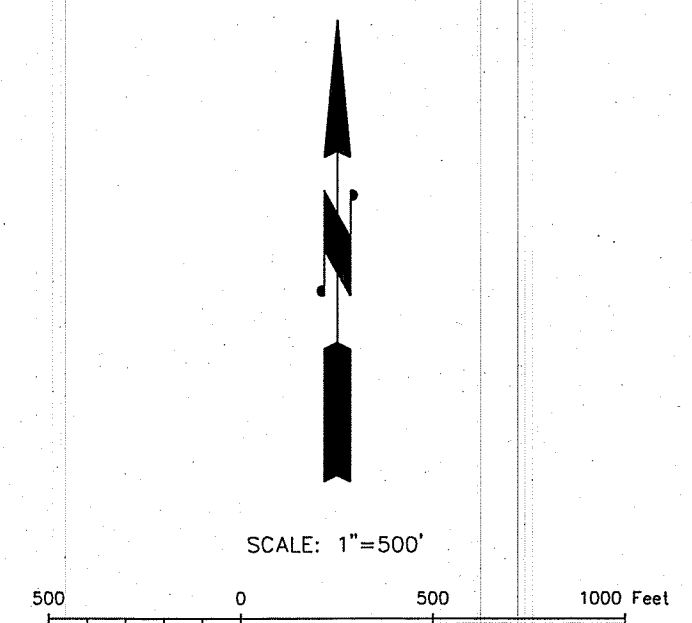

**NATHAN FENNY
SURVEY A-261**

TRACT 1
519.53 ACRES

ANDREW LONNIE SIKES, INC.
SURVEYING & MAPPING
11415 BEDFORD STREET
HOUSTON, TX 77031
PHONE (281) 561-8118

PREPARED: JUNE 11, 2013

SCALE: 1"=500'

A&S ENGINEERS, INC.
10377 STELLA LINK RD.
HOUSTON TX 77025-5445
PHONE: (713) 942-2700 • FAX: (713) 942-2799